

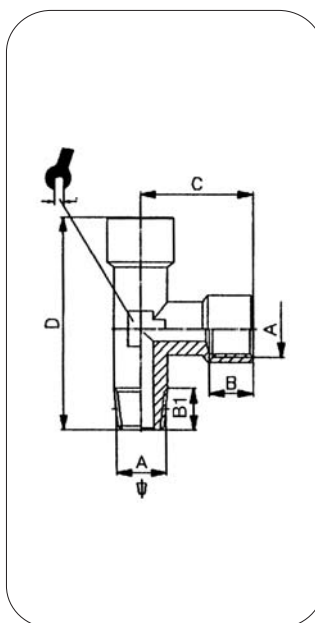

ART. 113 T M.F.F.
Off-set male tee

CODICE	A	B	B1	C	D		
11318	G _{1/8}	7,0	8,0	20,0	39,0	10,0	50
11314	G _{1/4}	8,0	11,0	25,5	49,5	13,0	25
11338	G _{3/8}	10,0	13,6	29,0	55,5	17,0	25
11312	G _{1/2}	11,0	15,5	35,0	65,0	20,0	10
11334	G _{3/4}	16,0	15,0	31,0	67,0	25,0	5
11301	G _{1"}	19,0	16,0	44,0	84,0	30,0	5



ART. 114 Croce F.F.F.
Female cross

CODICE	A	B	C		
11418	G _{1/8}	7,0	40,0	10,0	25
11414	G _{1/4}	8,0	51,0	13,0	25
11438	G _{3/8}	10,0	58,0	17,0	10
11412	G _{1/2}	11,0	72,0	20,0	5

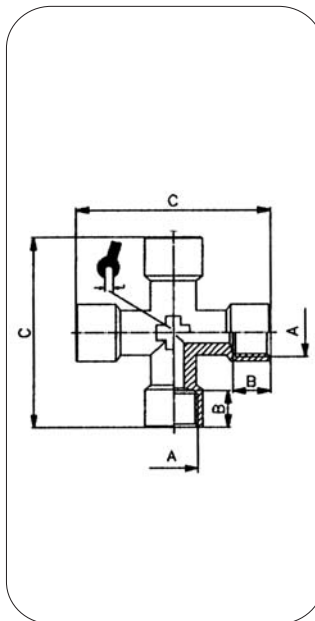

ART. 115 Elle M.M.
Male elbow

CODICE	A	B	C	A1	B1		
11518	G _{1/8}	8,0	19,0			10,0	100
11514	G _{1/4}	12,5	24,0			13,0	50
11538	G _{3/8}	13,6	26,5			17,0	25
11512	G _{1/2}	15,5	31,5			20,0	25
11534	G _{3/4}	15,0	35,5			25,0	5
11501	G _{1"}	16,0	51,0			30,0	5
1151814	G _{1/8}	8,0	22,0	G _{1/4}	12,5	13,0	100

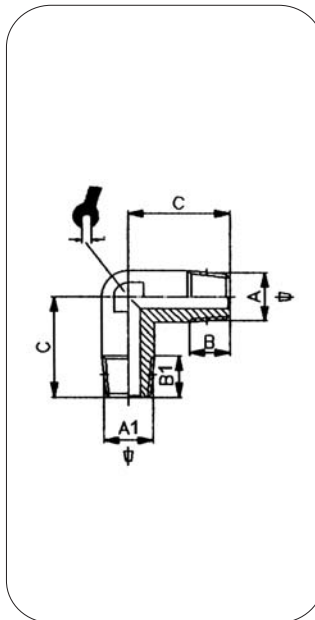

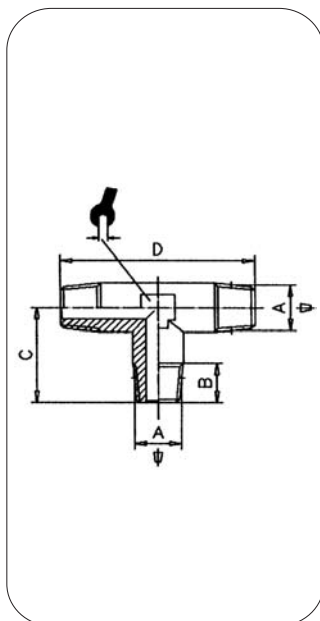
ART. 116 T.M.M.
Male tee

CODICE	A	B	C	D		
11618	G _{1/8}	8,0	19,0	38,0	10,0	100
11614	G _{1/4}	12,5	24,0	48,0	13,0	50
11638	G _{3/8}	13,6	26,5	53,0	17,0	25
11612	G _{1/2}	15,5	31,5	63,0	20,0	10
11634	G _{3/4}	15,0	35,5	66,0	25	5
11601	G _{1"}	16	40,5	78,0	30	5

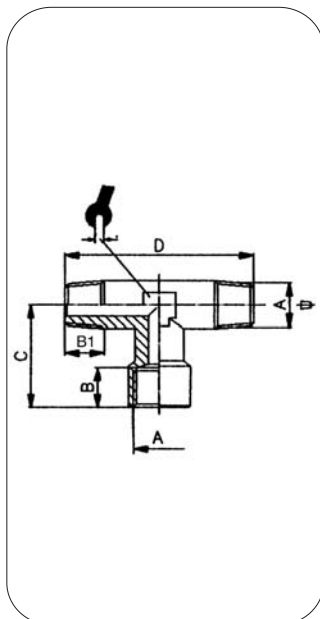
ART. 117 T.M.F.M.
Centre female tee

CODICE	A	B	B1	C	D		
11718	G _{1/8}	7,0	8,0	20,0	38,0	10,0	100
11714	G _{1/4}	8,0	12,5	25,5	48,0	13,0	50
11738	G _{3/8}	10,0	13,6	29,0	53,0	17,0	25
11712	G _{1/2}	11,0	15,5	36,0	63,0	20,0	10
11734	G _{3/4}	16,0	15,0	34,5	66,0	25,0	5
11701	G _{1"}	19,0	16,0	46,5	78	30,0	5

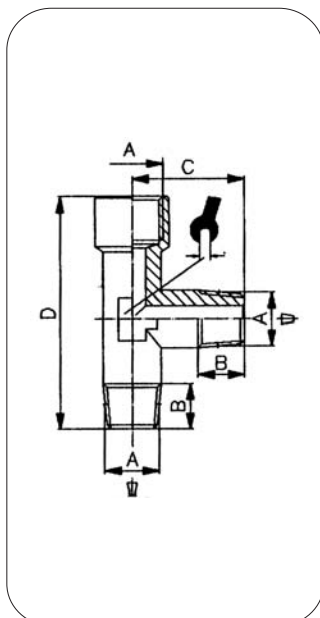
ART. 118 T.M.F.F.
Off-set female tee

CODICE	A	B	C	D		
11818	G _{1/8}	8,0	19	39	10	100
11814	G _{1/4}	12,5	24	49,5	13	50
11838	G _{3/8}	13,6	26,5	55,5	17	25
11812	G _{1/2}	15,5	31,5	67,5	20	10
11834	G _{3/4}	15,0	34,5	69,0	25	5
11801	G _{1"}	16,0	38	84	30	5



ART. 119 Portagomma maschio con O-Ring Male hose adapter + O-Ring

CODICE	ØD	A	I	H		
1190718	7,0	G _{1/8}	6,0	31,5	13,0	100
1190714	7,0	G _{1/4}	8,0	34,0	16,0	100
1190818	8,0	G _{1/8}	6,0	31,5	13,0	100
1190918	9,0	G _{1/8}	6,0	31,5	13,0	100
1190914	9,0	G _{1/4}	8,0	34,0	16,0	100
1190938	9,0	G _{3/8}	9,0	35,0	17,0	50
1191018	10,0	G _{1/8}	6,0	31,5	13,0	50
1191014	10,0	G _{1/4}	8,0	34,0	16,0	50
1191038	10,0	G _{3/8}	9,0	35,0	17,0	50
1191214	12,0	G _{1/4}	8,0	34,0	16,0	50
1191238	12,0	G _{3/8}	9,0	36,0	17,0	50
1191212	12,0	G _{1/2}	11,0	37,0	22,0	50
1191738	17,0	G _{3/8}	9,0	36,0	17,0	50
1191712	17,0	G _{1/2}	11,0	37,0	22,0	50
1191812	18,0	G _{1/2}	11,0	37,0	22,0	50

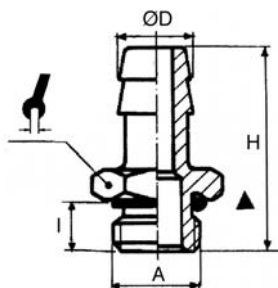

ART. 119z Portagomma maschio cilindrico Male hose adapter

CODICE	ØD	A	I	H		
119Z0618	6,0	G _{1/8}	6,0	29,5	12,0	100
119Z0614	6,0	G _{1/4}	8,0	33,0	17,0	100
119Z0718	7,0	G _{1/8}	6,0	30,5	14,0	100
119Z0714	7,0	G _{1/4}	8,0	33,0	17,0	100
119Z0818	8,0	G _{1/8}	6,0	30,5	14,0	100
119Z0814	8,0	G _{1/4}	8,0	33,0	17,0	100
119Z0838	8,0	G _{3/8}	9,0	34,0	19,0	100
119Z0918	9,0	G _{1/8}	6,0	30,5	14,0	100
119Z0914	9,0	G _{1/4}	8,0	33,0	17,0	100
119Z0938	9,0	G _{3/8}	9,0	34,0	19,0	100
119Z0912	9,0	G _{1/2}	14,0	39,0	22,0	25
119Z1018	10,0	G _{1/8}	6,0	30,5	14,0	100
119Z1014	10,0	G _{1/4}	8,0	33,0	17,0	100
11941038	10,0	G _{3/8}	9,0	34,0	19,0	100
119Z1012	10,0	G _{1/2}	10,0	42,0	24,0	50
119Z1214	12,0	G _{1/4}	8,0	33,0	17,0	50
119Z1238	12,0	G _{3/8}	9,0	34,0	19,0	50
119Z1212	12,0	G _{1/2}	10,0	35,5	24,0	50
119Z1438	14,0	G _{3/8}	9,0	34,0	19,0	50
119Z1412	14,0	G _{1/2}	10,0	35,5	24,0	50
119Z1638	16,0	G _{3/8}	9,0	38,0	19,0	50
119Z1612	16,0	G _{1/2}	10,0	42,0	24,0	50
119Z1738	17,0	G _{3/8}	9,0	34,0	19,0	50
119Z1712	17,0	G _{1/2}	10,0	35,5	24,0	50
119Z2012	20,0	G _{1/2}	10,0	35,5	24,0	25

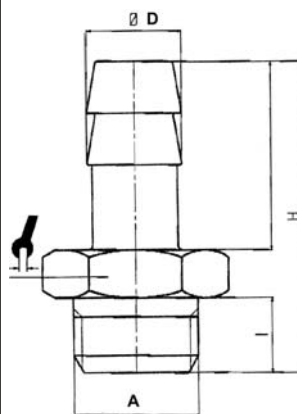

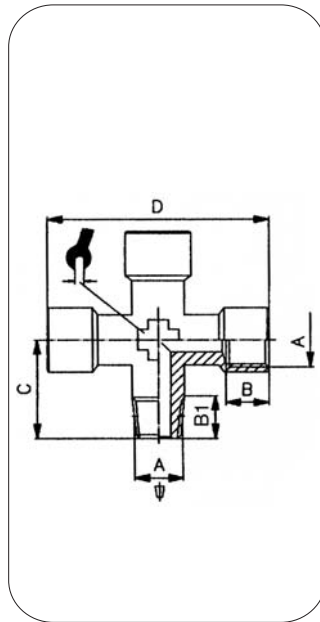

ART. 120 Croce M.F.F.
1 male 3 female cross

CODICE	A	B	B1	C	D		
12018	G _{1/8}	7,0	8,0	19,0	40,0	10,0	25
12014	G _{1/4}	8,0	12,5	24,0	51,0	13,0	25
12038	G _{3/8}	10,0	13,6	26,5	58,0	17,0	10
12012	G _{1/2}	11,0	15,5	31,5	72,0	20,0	5

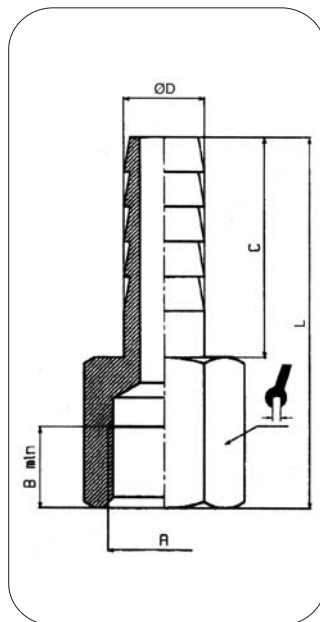

ART. 122 Portagomma femmina
Female Hose adapter

CODICE	ØD	A	B	C	L		
1220618	6,0	G _{1/8}	7,0	19,0	32,0	12,0	100
1220718	7,0	G _{1/8}	7,0	19,0	32,0	12,0	100
1220714	7,0	G _{1/4}	8,0	19,0	35,0	17,0	100
1220814	8,0	G _{1/4}	8,0	19,0	35,0	17,0	100
1220914	9,0	G _{1/4}	8,0	19,0	35,0	17,0	100
1221038	10,0	G _{3/8}	10,0	19,0	37,0	20,0	50
1221238	12,0	G _{3/8}	10,0	19,0	37,0	20,0	50
1221212	12,0	G _{1/2}	11,0	19,0	40,5	24,0	50

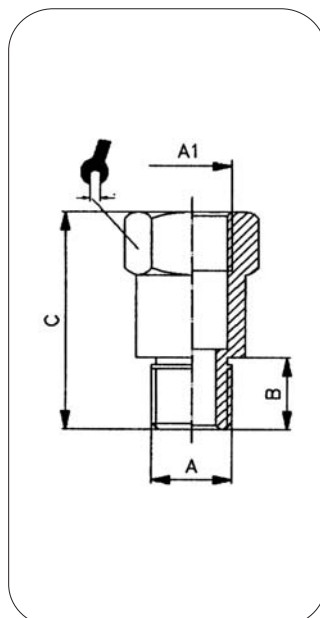

ART. 123 Prolunga
Extension

CODICE	A	A1	B	C		
1231822	G _{1/8}	G _{1/8}	6,0	22,0	14,0	100
1231832	G _{1/8}	G _{1/8}	6,0	32,0	14,0	100
1231842	G _{1/8}	G _{1/8}	6,0	42,0	14,0	100
1231851	G _{1/8}	G _{1/8}	6,0	51,0	14,0	50
1231428	G _{1/4}	G _{1/4}	8,0	28,0	17,0	100
1231435	G _{1/4}	G _{1/4}	8,0	35,0	17,0	50
1231451	G _{1/4}	G _{1/4}	8,0	51,0	17,0	50



ART. 125 Y maschio Male Y

CODICE	A	B			
12518	G _{1/8}	8,0		13,0	50
12514	G _{1/4}	11,0		17,0	25
12538	G _{3/8}	11,5		20,0	25
12512	G _{1/2}	14,0		25,0	10

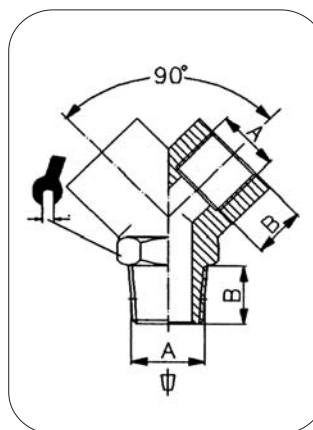

ART. 126 Y femmina Female Y

CODICE	A	B			
12618	G _{1/8}	8,0		13,0	50
12614	G _{1/4}	11,0		17,0	25
12638	G _{3/8}	11,5		20,0	25
12612	G _{1/2}	14,0		25,0	10

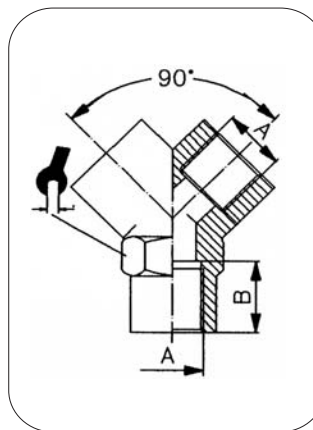

ART. 127 Passaparete femmina non nichelato Female bulkhead no nickel plated

CODICE	G	A	B	C			
127M5	M5	M10x1	10,5	14,0	14,0	14,0	100
12718	G _{1/8}	M16x1,5	14,0	18,0	22,0	19,0	100
12714	G _{1/4}	M20x1,5	21,0	25,0	27,0	24,0	50
12738	G _{3/8}	M26x1,5	21,0	26,0	32,0	30,0	25
12712	G _{1/2}	M28x1,5	27,0	33,0	36,0	32,0	10

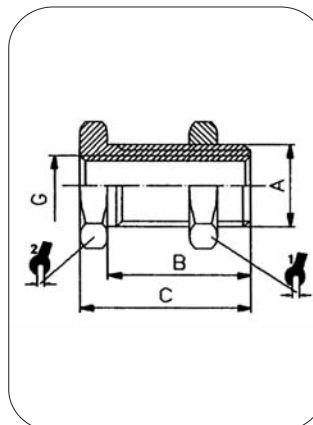

ART. 128 Croce M.M.M.M. Male cross

CODICE	A	B	C		
12818	G _{1/8}	8,0	38,0		

