



ART. 01



Diritto filetto cilindrico maschio con O-Ring
Straight male adaptor (parallel)

CODICE	ØD	G	ØC	ØB	H	L			
0104M5	4,0	M5	2,6	9,0	5,0	20,5		2,5	50
0104M6	4,0	M6	2,6	9,0	5,0	20,5		2,5	50
010418	4,0	G _{1/8}	2,6	13,5	6,0	20,0	9,0	2,5	50
010414	4,0	G _{1/4}	2,6	17,0	8,0	21,0	9,0	2,5	50
0106M5	6,0	M5	2,6	11,0	4,0	22,8		2,5	50
010618	6,0	G _{1/8}	4,2	13,5	6,0	25,3	11,0	4,0	50
010614	6,0	G _{1/4}	4,2	17,0	8,0	24,3	11,0	4,0	50
010818	8,0	G _{1/8}	5,2	12,8	6,0	27,0	13,0	5,0	50
010814	8,0	G _{1/4}	6,2	17,0	8,2	25,5	13,0	6,0	50
010838	8,0	G _{3/8}	6,2	20,0	9,0	25,5	13,0	6,0	50
011014	10,0	G _{1/4}	7,3	16,0	8,0	30,4	16,0	7,0	50
011038	10,0	G _{3/8}	8,3	21,0	9,0	30,9	16,0	8,0	50
011214	12,0	G _{1/4}	7,3	16,0	8,0	33,2	19,0	7,0	25
011238	12,0	G _{3/8}	10,3	22,0	9,0	33,2	19,0	10,0	25
011212	12,0	G _{1/2}	10,3	24,0	11,0	33,2	19,0	10,0	25
011438	14,0	G _{3/8}	10,3	21,0	9,0	35,0	21,0	10,0	25
011412	14,0	G _{1/2}	10,3	24,0	11,0	32,5	21,0	10,0	25

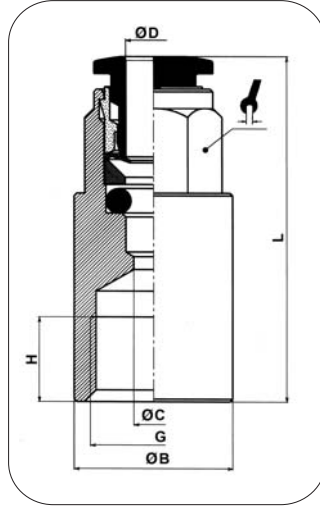

ART. 02

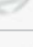

Diritto femmina
Straight female adaptor

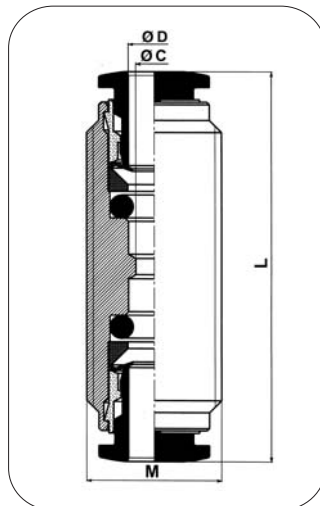
CODICE	ØD	G	ØC	ØB	H	L			
020418	4,0	G _{1/8}	3,0	12,0	6,5	26,5	9,0		50
020414	4,0	G _{1/4}	3,0	17,0	10,0	29,5	9,0		50
020618	6,0	G _{1/8}	5,0	12,0	6,5	28,3	11,0		50
020614	6,0	G _{1/4}	5,0	17,0	10,0	31,3	11,0		50
020818	8,0	G _{1/8}	7,0	12,0	6,5	28,5	13,0		50
020814	8,0	G _{1/4}	7,0	17,0	10,0	32,5	13,0		50

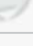

ART. 03

Diritto innestabile
Straight connector

CODICE	ØD	ØC	M	L			
030400	4,0	3,0	11x1	32,0			50
030600	6,0	5,0	14x1	36,1			50
030800	8,0	7,0	16x1	38,0			50
031000	10,0	9,0	18x1	42,3			50
031200	12,0	11,0	22x1	45,8			25
031400	14,0	13,0	24x1	47,5			25



"RAP"

Raccordi automatici in ottone Brass push - in fittings

ART. 04

Gomito innestabile
Elbow connector

CODICE	ØD	ØC	ØB	L	
040400	4,0	4,0	10,0	19,0	50
040600	6,0	5,0	11,0	20,6	50
040800	8,0	7,0	13,0	23,0	50
041000	10,0	8,0	16,0	26,4	50
041200	12,0	10,0	19,0	28,9	25
041400	14,0	12,0	21,0	31,5	25

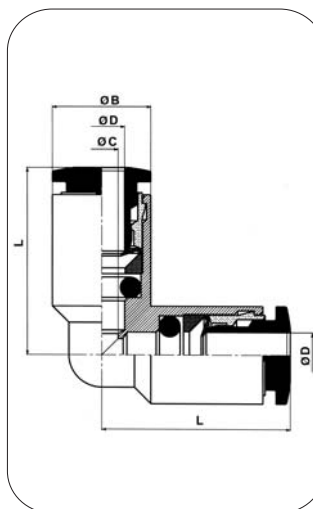

ART. 05

T innestabile
T connector

CODICE	ØD	ØC	ØB	L	
050400	4,0	3,0	9,0	17,3	50
050600	6,0	5,0	11,0	20,6	50
050800	8,0	7,0	13,0	23,0	50
051000	10,0	8,0	16,0	26,4	25
051200	12,0	10,0	19,0	28,9	25
051400	14,0	12,0	21,0	31,5	25

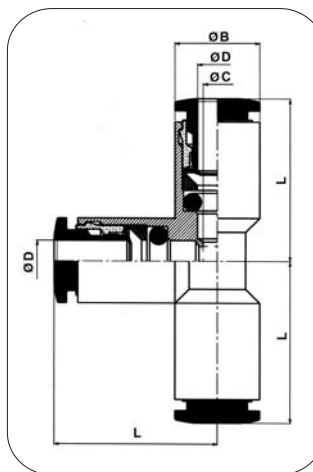

ART. 06

Innesto, filetto cilindrico con O-Ring
Adaptor parallel (short)

CODICE	ØD	G	ØC	ØB	H	L	ØA		
0604M5	4,0	M5	2,0	8,0	4,0	24,2	2,0	8,0	50
060418	4,0	G _{1/8}	2,0	13,0	6,0	27,7	6,0	13,0	50
060414	4,0	G _{1/4}	2,0	16,0	8,0	30,2	7,5	13,0	50
0606M5	6,0	M5	2,6	8,0	4,0	26,0	2,6	8,0	50
060618	6,0	G _{1/8}	4,0	13,0	6,0	29,5	6,0	13,0	50
060614	6,0	G _{1/4}	4,0	16,0	8,0	32,0	7,5	13,0	50
060818	8,0	G _{1/8}	6,0	13,0	6,0	31,0	6,0	13,0	50
060814	8,0	G _{1/4}	6,0	16,0	8,0	33,5	7,5	13,0	50
060838	8,0	G _{3/8}	6,0	20,0	9,0	35,5	9,0	13,0	50
061018	10,0	G _{1/8}	6,0	13,0	6,0	35,5	6,0	13,0	50
061014	10,0	G _{1/4}	8,0	16,0	8,0	38,0	8,0	13,0	50
061038	10,0	G _{3/8}	8,0	20,0	9,0	41,0	8,0	13,0	50
061214	12,0	G _{1/4}	8,0	16,0	8,0	39,0	8,0	13,0	25
061238	12,0	G _{3/8}	10,0	20,0	9,0	42,0	11,0	13,0	25
061212	12,0	G _{1/2}	10,0	24,0	11,0	44,0	13,0	16,0	25
061438	14,0	G _{3/8}	12,0	20,0	9,0	44,5	12,0	16,0	25
061412	14,0	G _{1/2}	12,0	24,0	11,0	46,5	13,0	16,0	25

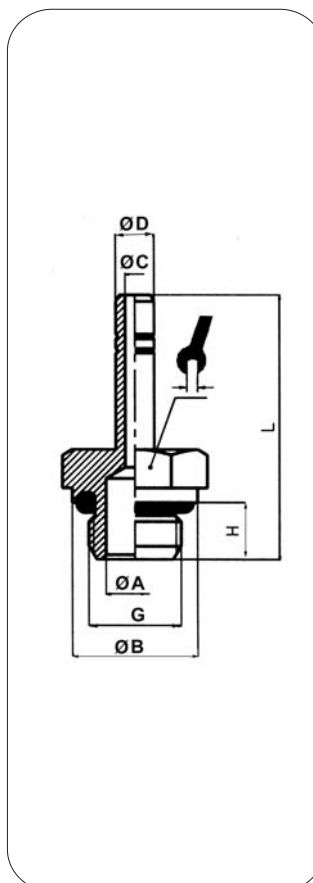

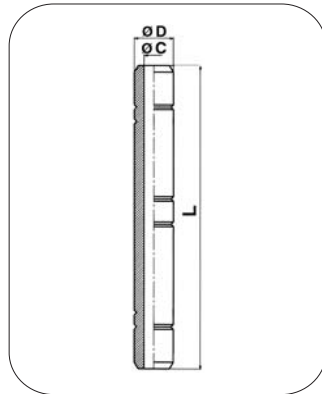

ART. 07 Prolungamento
Connector

CODICE	ØD	ØC	L	■
070400	4,0	2,0	32,5	100
070600	6,0	4,0	39,0	50
070800	8,0	6,0	42,0	50
071000	10,0	8,0	48,0	50
071200	12,0	10,0	50,0	25
071400	14,0	12,0	53,0	25

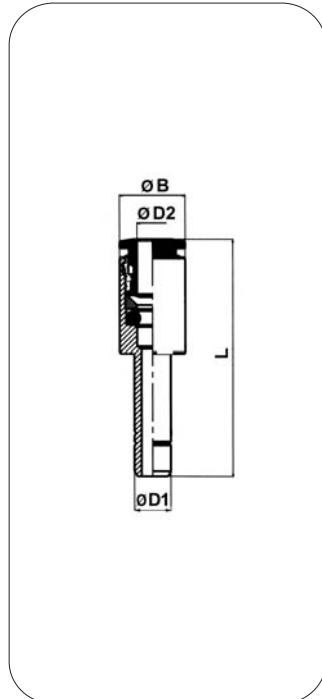

ART. 08 Riduzione con codolo
Plug-in reducer

CODICE	ØD1	ØD2	ØB	L	■
080604	6,0	4,0	9,0	31,0	50
080804	8,0	4,0	9,0	32,5	50
080806	8,0	6,0	11,0	34,8	50
081006	10,0	6,0	11,0	39,3	50
081008	10,0	8,0	13,0	39,0	50
081204	12,0	4,0	13,0	40,0	25
081206	12,0	6,0	13,0	40,3	25
081208	12,0	8,0	13,0	39,5	25
081210	12,0	10,0	16,0	42,4	25
081404	14,0	4,0	15,0	43,5	25
081406	14,0	6,0	15,0	43,8	25
081408	14,0	8,0	15,0	44,0	25
081410	14,0	10,0	16,0	44,9	25
081412	14,0	12,0	19,0	45,9	25

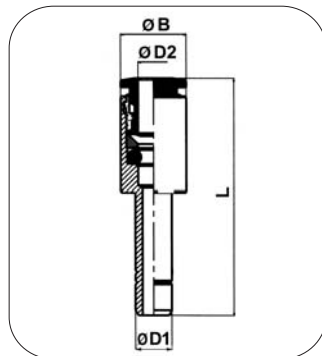

ART. 08/E Maggiorazione con codolo
Plug-in increaser

CODICE	ØD1	ØD2	ØB	L	■
08E0406	4,0	6,0	11,0	35,5	50
08E0608	6,0	8,0	13,0	39	50

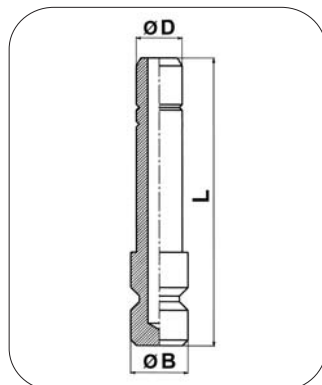

ART. 09 Tappo
Plug

CODICE	ØD	ØB	L	■
090400	4,0	5,0	25,5	50
090600	6,0	7,0	27,5	50
090800	8,0	9,0	30,0	50
091000	10,0	11,0	35,0	50
091200	12,0	13,0	37,0	25
091400	14,0	15,0	39,5	25

**"RAP"**

Raccordi automatici in ottone

Brass push - in fittings

ART. 10
Passaparete
 Bulkhead connector

CODICE	ØD	ØC	M	IMAX	L		
100400	4,0	3,0	11x1	8,0	32,0	14,0	50
100600	6,0	5,0	14x1	8,0	36,1	17,0	50
100800	8,0	7,0	16x1	10,0	38,0	19,0	50
101000	10,0	9,0	18x1	12,0	42,3	21,0	25
101200	12,0	11,0	22x1	17,0	45,8	20,0	25
101400	14,0	13,0	24x1	18,0	47,5	27,0	25

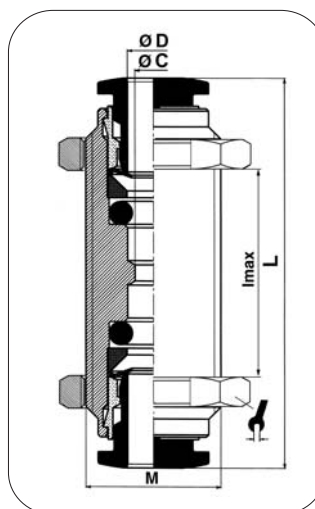
**ART. 13**
Anello semplice
 Single banjo body

CODICE	ØD	G	ØA	ØB	H	L	
1304M5	4,0	M5	5,0	8,0	9,0	19,5	50
130418	4,0	G _{1/8}	9,9	14,0	15,0	21,1	50
130618	6,0	G _{1/8}	9,9	14,0	15,0	24,3	50
130614	6,0	G _{1/4}	13,3	18,0	17,0	25,5	50
130818	8,0	G _{1/8}	9,9	14,0	15,0	24,8	50
130814	8,0	G _{1/4}	13,3	18,0	17,0	26,5	50
130838	8,0	G _{3/8}	16,75	21,0	20,0	28,0	50
131014	10,0	G _{1/4}	13,3	18,0	17,0	28,4	50
131038	10,0	G _{3/8}	16,75	21,0	20,0	29,9	25
131238	12,0	G _{3/8}	16,75	21,0	20,0	31,4	25
131212	12,0	G _{1/2}	21,0	26,0	24,0	34,9	25
131412	14,0	G _{1/2}	21,0	26,0	24,0	35,5	25

G = per filettatura - Thread side

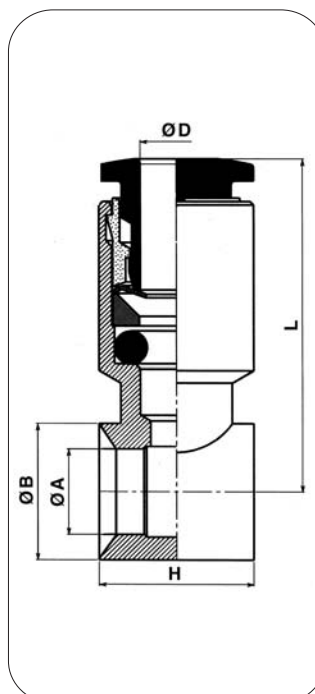
**ART. 14**
Anello doppio
 Double banjo body

CODICE	ØD	G	ØA	ØB	H	L	
1404M5	4,0	M5	5,0	8,0	9,0	19,5	50
140418	4,0	G _{0,5}	9,9	14,0	15,0	21,1	50
140618	6,0	G _{1/8}	9,9	14,0	15,0	24,3	50
140614	6,0	G _{1/4}	13,3	18,0	17,0	25,5	50
140818	8,0	G _{1/8}	9,9	14,0	15,0	24,8	50
140814	8,0	G _{1/4}	13,3	18,0	17,0	26,5	50
140838	8,0	G _{3/8}	16,75	21,0	20,0	28,0	50
141014	10,0	G _{1/4}	13,3	18,0	17,0	28,4	50
141038	10,0	G _{3/8}	16,75	21,0	20,0	29,9	25

G = per filettatura - Thread side

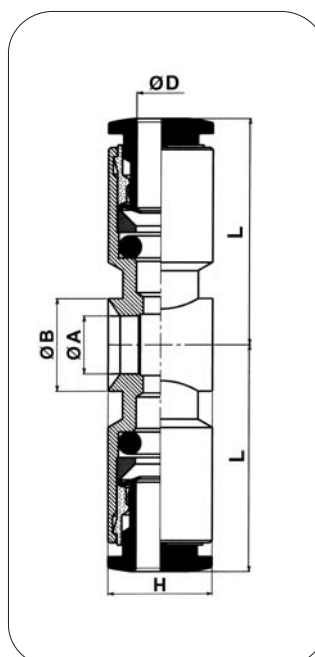

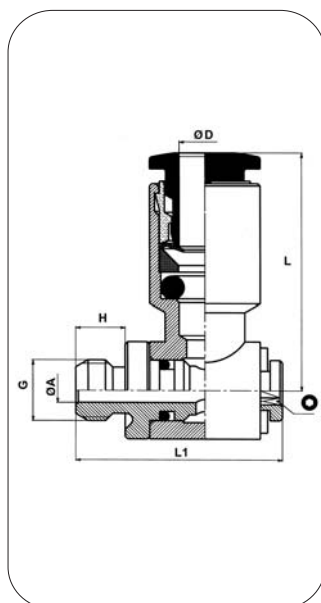
**ART. 15**

Anello semplice girevole con asta
Complete single banjo (rotating under pressure)

CODICE	ØD	G	ØA	H	L1	L	Ø	📦
1504M5	4,0	M5	2,0	4,0	16,8	19,5	2,0	50
1504M6	4,0	M6	2,0	4,0	16,8	19,5	2,0	50
150418	4,0	G _{1/8}	5,5	6,0	25,0	21,1	3,0	50
150618	6,0	G _{1/8}	5,5	6,0	25,0	24,3	3,0	50
150614	6,0	G _{1/4}	7,8	8,0	29,5	25,5	4,0	50
150818	8,0	G _{1/8}	5,5	6,0	25,0	24,8	3,0	50
150814	8,0	G _{1/4}	7,8	8,0	29,3	26,5	4,0	50
150838	8,0	G _{3/8}	10,0	9,0	34,0	28,0	5,0	25
151014	10,0	G _{1/4}	7,8	8,0	29,3	28,4	4,0	25
151038	10,0	G _{3/8}	10,0	9,0	34,0	29,9	5,0	25
151238	12,0	G _{3/8}	10,0	9,0	34,0	31,4	5,0	25
151212	12,0	G _{1/2}	12,0	11,0	40,8	34,9	8,0	20
151412	14,0	G _{1/2}	12,0	11,0	40,8	35,5	8,0	20

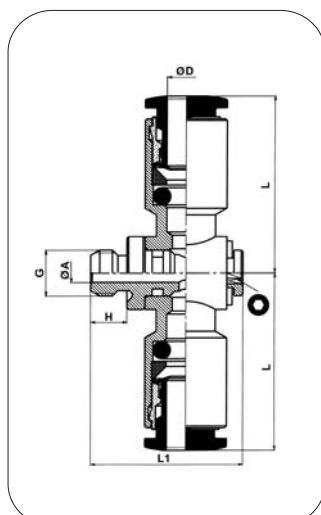
**ART. 16**

Anello doppio girevole con asta
Complete double banjo (rotating under pressure)

CODICE	ØD	G	ØA	H	L1	L	Ø	📦
1604M5	4,0	M5	2,0	4,0	16,8	19,5	2,0	50
160418	4,0	G _{1/8}	5,5	6,0	25,0	21,1	3,0	50
160618	6,0	G _{1/8}	5,5	6,0	25,0	24,3	3,0	50
160614	6,0	G _{1/4}	7,8	8,0	29,3	25,5	4,0	50
160818	8,0	G _{1/8}	5,5	6,0	25,0	24,8	3,0	50
160814	8,0	G _{1/4}	7,8	8,0	29,3	26,5	4,0	25
160838	8,0	G _{3/8}	10	9,0	34	28	5,0	25
161014	10,0	G _{1/4}	7,8	8,0	29,3	28,4	4,0	25
161038	10,0	G _{3/8}	12	11,0	40,8	34,9	8,0	25

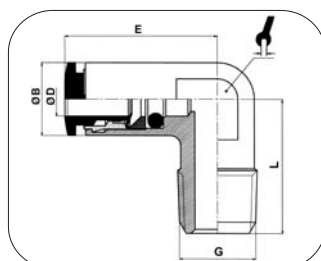
**ART. 19**

Raccordo ad elle fisso
Elbow male adaptor

CODICE	ØD	G	ØB	E	L	📏	📦
190418	4,0	G _{1/8}	9,0	18,6	16,5	10	100
190618	6,0	G _{1/8}	11,0	23,8	16,5	10	100
190818	8,0	G _{1/8}	13,0	25,5	18,5	11	100
190814	8,0	G _{1/4}	13,0	25,5	22,0	11	100

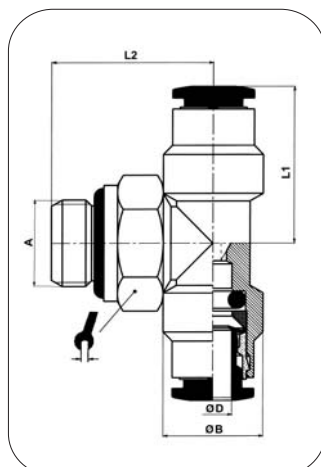
**ART. 20**

Raccordo a T centrale girevole
Swivel male stud tee parallel

CODICE	ØD	A	ØB	L1	L2	📏	📦
2004M5	4,0	M5	9,0	17,3	20,0	8,0	50
200418	4,0	G _{1/8}	11,0	17,3	18,5	13,0	50
200414	4,0	G _{1/4}	9,0	19,0	22,5	16,0	50
200618	6,0	G _{1/8}	11,0	20,6	18,5	13,0	50
200614	6,0	G _{1/4}	11,0	22,1	22,5	16,0	50
200818	8,0	G _{1/8}	13,0	23,0	20,5	13,0	50
200814	8,0	G _{1/4}	13,0	23,0	22,5	16,0	50
200838	8,0	G _{3/8}	13,0	24,5	25,5	18,0	25
201014	10,0	G _{1/4}	16,0	26,4	24,5	16,0	25
201038	10,0	G _{3/8}	16,0	26,4	25,5	18,0	25