



## 手控阀门/ HAND VALVES



### 作用/ APPLICATIONS

用来控制空气流向  
Used for switching compressed air.

手控阀门是控制气动装置空气压力的开与关。  
This product switched air on/off air pressure devices by simply turning the handle.  
当设备中剩余压力都释放后, 要进行必要的检查和维修保养。  
Maintenance or inspection is possible when the remaining pressure in the device is removed.  
手控阀门有四种类型供使用。  
There are 4 types available depending on the method applied to air pressure flow.

### 结构图/ STRUCTURE CHART

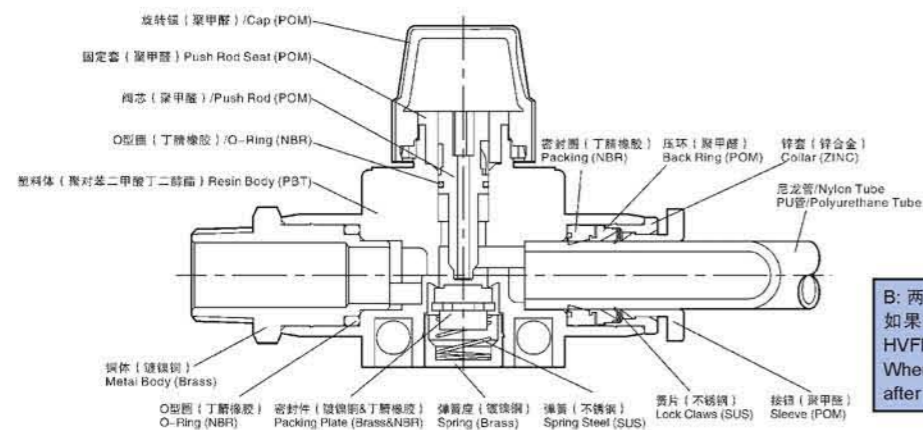

B: 两通/TWO WAY 空白/BLANK: 三通/THREE WAY  
如果你需要两通手阀, 请在型号后面加上B. 比如:  
HVFF06-06B.  
When you order Two-Way hand valve, please put B  
after model type. For example: HVFF06-06B

### 技术参数/ SPECIFICATIONS

使用流体/Fluid	空气 (无其他的气体 and 液体) / Air (No other gases or liquids)	
使用压力范围/Operating Pressure	0~150PSI	0~9.9Kgf/cm <sup>2</sup> (0~990KPa)
负压/Negative Pressure	-29.5in Hg	-750mmHg (-750Torr)
使用温度范围/ Operating Temperature	32~140°F	0~60°C
使用软管/Applicable Tube	PU及尼龙 / Polyurethane and Nylon	

### HVFF 管接型



MODEL	ΦC	ΦD	ΦP	Φd	E	F	L	H	M
HVFF 06-06(B)	6	6	15	4.2	16.5	24	52	41	18
HVFF 08-06(B)	8	6	15	4.2	16.5	24	52	41	18
HVFF 08-08(B)	8	8	15	4.2	16.5	24	52	41	18
HVFF 10-08(B)	10	8	21.5	4.2	21.5	29	63	45	22
HVFF 10-10(B)	10	10	21.5	4.2	21.5	29	63	45	22
HVFF 12-10(B)	12	10	21.5	4.2	21.5	29	63	45	22
HVFF 12-12(B)	12	12	21.5	4.2	21.5	29	63	45	22

### HVSS 螺纹连接性

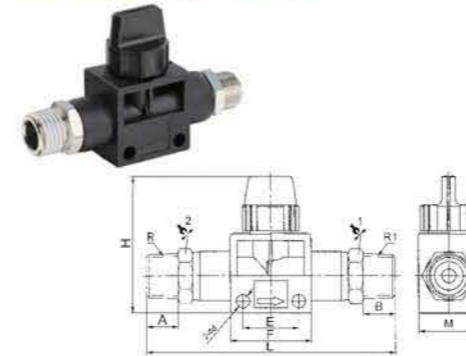

MODEL	R	R1	A	B	Φd	E	F	L	H	M	1	2
HVSS 01-01(B)	R1/8	R1/8	7.5	7.5	4.2	16.5	24	68	41	18	14	14
HVSS 02-01(B)	R1/4	R1/8	9.5	7.5	4.2	16.5	24	70	41	18	14	14
HVSS 02-02(B)	R1/4	R1/4	9.5	9.5	4.2	16.5	24	72	41	18	14	14
HVSS 03-02(B)	R3/8	R1/4	10.5	9.5	4.2	16.5	29	74	45	22	21	21
HVSS 03-03(B)	R3/8	R3/8	10.5	10.5	4.2	21.5	29	84	45	22	21	21
HVSS 04-03(B)	R1/2	R3/8	13.5	10.5	4.2	21.5	29	87	45	22	21	21
HVSS 04-04(B)	R1/2	R1/2	13.5	13.5	4.2	21.5	29	90	45	22	21	21

### HVSF 由插管端流向螺纹端型

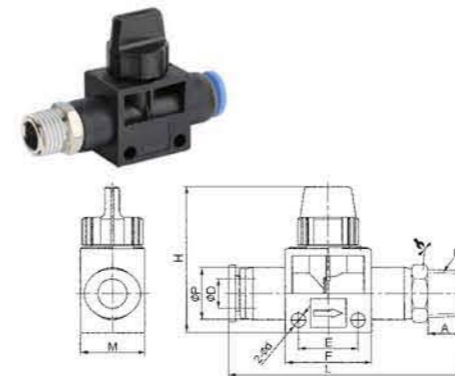

MODEL	ΦD	R	A	ΦP	Φd	E	F	L	H	M	
HVSF 06-01(B)		R1/8	7.5	15	4.2	16.5	24	63	41	18	14
HVSF 06-02(B)	6	R1/4	9.5	15	4.2	16.5	24	65	41	18	14
HVSF 06-03(B)		R3/8	10.5	15	4.2	16.5	24	66	41	18	17
HVSF 08-01(B)		R1/8	7.5	15	4.2	16.5	24	63	41	18	14
HVSF 08-02(B)	8	R1/4	9.5	15	4.2	16.5	24	65	41	18	14
HVSF 08-03(B)		R3/8	10.5	15	4.2	16.5	24	66	41	18	17
HVSF 10-02(B)		R1/4	9.5	21.5	4.2	21.5	29	72	45	22	21
HVSF 10-03(B)	10	R3/8	10.5	21.5	4.2	21.5	29	73	45	22	21
HVSF 10-04(B)		R1/2	13.5	21.5	4.2	21.5	29	76	45	22	21
HVSF 12-02(B)		R1/4	9.5	21.5	4.2	21.5	29	72	45	22	21
HVSF 12-03(B)	12	R3/8	10.5	21.5	4.2	21.5	29	73	45	22	21
HVSF 12-04(B)		R1/2	13.5	21.5	4.2	21.5	29	76	45	22	21

### HVFS 由螺纹端流向插管端型

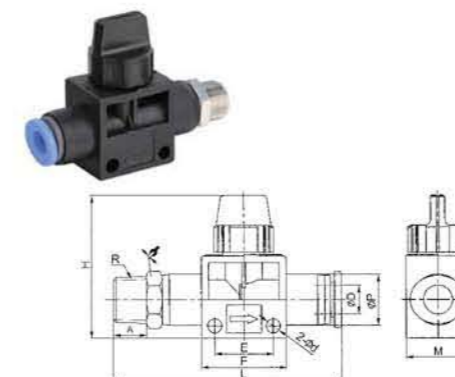

MODEL	ΦD	R	A	ΦP	Φd	E	F	L	H	M	
HVFS 01-06(B)		R1/8	7.5	15	4.2	16.5	24	63	41	18	14
HVFS 02-06(B)	6	R1/4	9.5	15	4.2	16.5	24	65	41	18	14
HVFS 03-06(B)		R3/8	10.5	15	4.2	16.5	24	66	41	18	17
HVFS 01-08(B)		R1/8	7.5	15	4.2	16.5	24	63	41	18	14
HVFS 02-08(B)	8	R1/4	9.5	15	4.2	16.5	24	65	41	18	14
HVFS 03-08(B)		R3/8	10.5	15	4.2	16.5	24	66	41	18	17
HVFS 02-10(B)		R1/4	9.5	21.5	4.2	21.5	29	72	45	22	21
HVFS 03-10(B)	10	R3/8	10.5	21.5	4.2	21.5	29	73	45	22	21
HVFS 10-04(B)		R1/2	13.5	21.5	4.2	21.5	29	76	45	22	21
HVFS 02-12(B)		R1/4	9.5	21.5	4.2	21.5	29	72	45	22	21
HVFS 03-12(B)	12	R3/8	10.5	21.5	4.2	21.5	29	73	45	22	21
HVFS 04-12(B)		R1/2	13.5	21.5	4.2	21.5	29	76	45	22	21



**BVU 球阀**

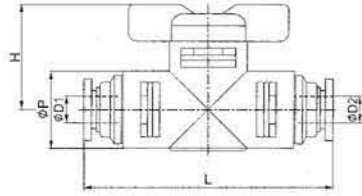

MODEL	ΦD1	ΦD2	ΦP	L	H
BVU06	6	6	17	56	23
BVU08	8	8	17	58	23
BVU10	10	10	24	78	28
BVU12	12	12	24	80	28
BVU08-06	8	6	17	57	23
BVU12-10	12	10	24	79	28

**BVC 球阀**

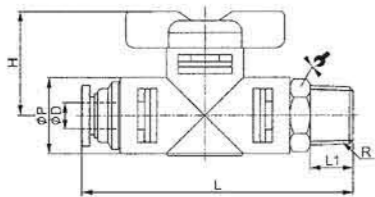

MODEL	ΦD	R	ΦP	L	L1	H	⚡
BVC06-01	6	R1/8	17	58	7.5	23	17
BVC06-02		R1/4	17	60	9.5	23	17
BVC06-03		R3/8	17	61	10.5	23	17
BVC08-01	8	R1/8	17	59	7.5	23	17
BVC08-02		R1/4	17	61	9.5	23	17
BVC08-03		R3/8	17	62	10.5	23	17
BVC10-02	10	R1/4	24	82	9.5	28	24
BVC10-03		R3/8	24	83	10.5	28	24
BVC10-04		R1/2	24	86	13.5	28	24
BVC12-02	12	R1/4	24	83	9.5	28	24
BVC12-03		R3/8	24	84	10.5	28	24
BVC12-04		R1/2	24	87	13.5	28	24

**手滑阀ISV(Hand Sliding Fitting)**

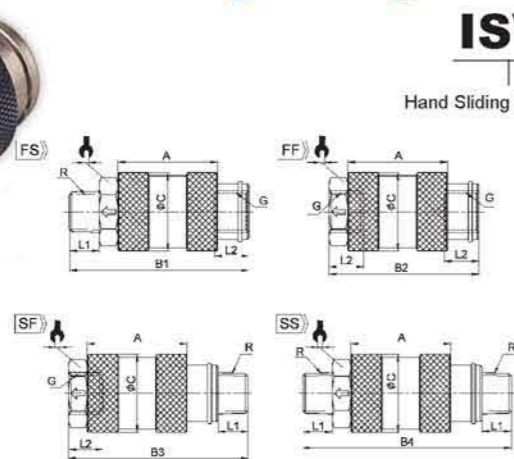

**ISV 01 - SS**

Hand Sliding Fittings

FS: 内外牙型 (标准型)  
Female-Male (standard type)  
SS: 双外牙型/Male-Male  
FF: 双内牙型/Female-Female  
SF: 外内牙型/Male-Female

螺纹型号  
Thread Size  
01=1/8"  
02=1/4"  
03=3/8"  
04=1/2"

MODEL	A	B1	B2	B3	B4	ΦC	L1	L2	G	R	⚡
ISV 01	20	40	32	40	47	20	7.5	8.5	G1/8	R1/8	14
ISV 02	32	58	48	58	68	25	9.5	11.5	G1/4	R1/4	19
ISV 03	32	59	48	59	69	30	10.5	12.5	G3/8	R3/8	22
ISV 04	40	72	58	72	85	37	13.5	15.5	G1/2	R1/2	27

**迷你接头 MINI FITTINGS**



**特点/ FEATURES**

- 超小型产品 (COMPACT), 比普通型号体积小40%, 外型尺寸小20%, 是小型化的ONE-TOUCH FITTING.
- 由于表面有镀铬处理, 所以耐腐蚀性突出.

**结构图/ STRUCTURE CHART**

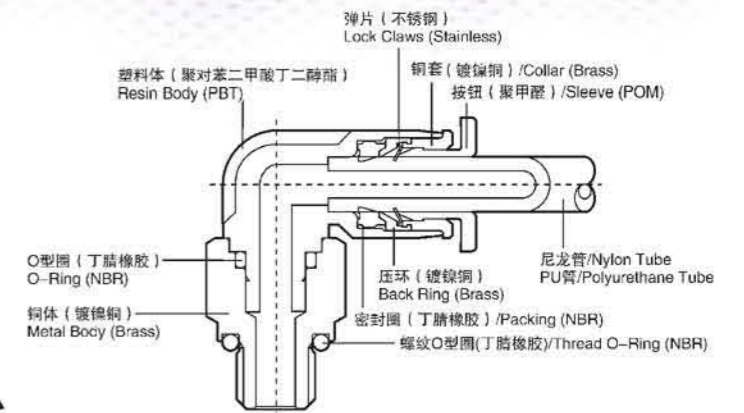

**公制-锥螺纹/ METRIC-BSPT( R)**

**PC 06 - 01 C**

超小型接头  
Compact one touch fitting

气管直径  
Tube Dia  
规格/Code 尺寸/Size  
03 Φ3  
04 Φ4  
06 Φ6

螺纹型号  
Thread Size  
公制螺纹/ Metric Thread  
规格/Code 型号/Size  
M3 M3x0.5  
M5 M5x0.8  
M6 M6x1.0  
锥螺纹/ R (PT) Thread  
型号/Code 尺寸/Size  
01 R1/8

超小型  
Compact Nickel

**技术参数/ SPECIFICATIONS**

使用流体/Fluid	空气 (无其他气体和液体) /Air (No other gases or liquids)	
使用压力范围/Operating Pressure	0-150PSI	0~9.9Kgf/cm <sup>2</sup> ( 0~990kpa )
负压/Negative Pressure	-29.5in Hg	-750mmHg ( 10Torr )
使用温度范围/ Operating Temperature	32~140°F	0~60°C
使用软管/Applicable Tube	PU及尼龙/Polyurethane and Nylon	