

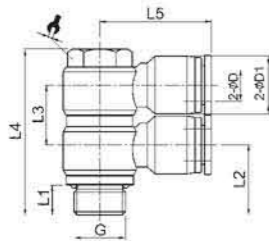

IPHT-G (2) 串联直角 (2) -G螺纹



MODEL	ΦD	G	L1	L2	L3	L4	L5	ΦD1	🔧
IPHT04-G01(2)	4	G1/8	5.5	14	15	38	23.5	11.5	12
IPHT04-G02(2)		G1/4	7.5	17.3	15	41.5	25.5	11.5	14
IPHT06-G01(2)	6	G1/8	5.5	14	15	38	23.5	13.5	12
IPHT06-G02(2)		G1/4	7.5	17.3	15	41.5	25.4	13.5	14
IPHT06-G03(2)	8	G3/8	7.5	19	15.7	49.5	29.5	13.5	19
IPHT08-G01(2)		G1/8	5.5	15	15	38	26.5	15	12
IPHT08-G02(2)	8	G1/4	7.5	18.3	15	41.5	29	15	14
IPHT08-G03(2)		G3/8	7.5	19	15.7	49.5	30	15	19
IPHT08-G04(2)	10	G1/2	10	24.5	21.5	57	32.5	15	24
IPHT10-G01(2)		G1/8	5.5	16.8	19	42.5	30.5	19	12
IPHT10-G02(2)	10	G1/4	7.5	20	21.5	44.8	32.5	19	14
IPHT10-G03(2)		G3/8	7.5	21	21.5	53	33	19	19
IPHT10-G04(2)	12	G1/2	10	25	21.5	60	36	19	24
IPHT12-G02(2)		G1/4	7.5	21.5	21.5	44.8	33.5	21.5	14
IPHT12-G03(2)	12	G3/8	7.5	22	21.5	53	35.5	21.5	19
IPHT12-G04(2)		G1/2	10	26	21.5	60.5	36.5	21.5	24

IPHT-G (3) 串联直角 (3) -G螺纹

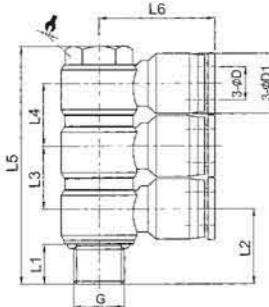

MODEL	ΦD	G	L1	L2	L3	L4	L5	L6	ΦD1	🔧
IPHT04-G01(3)	4	G1/8	5.5	14	15	15	53	23.5	11.5	12
IPHT04-G02(3)		G1/4	7.5	17.3	15	15	56.3	25.5	11.5	14
IPHT06-G01(3)	6	G1/8	5.5	14	15	15	53	23.5	13.5	12
IPHT06-G02(3)		G1/4	7.5	17.3	15	15	56.3	25.4	13.5	14
IPHT06-G03(3)	8	G3/8	7.5	19	15.7	15.7	64.4	29.5	13.5	19
IPHT08-G01(3)		G1/8	5.5	15	15	15	53	26.5	15	12
IPHT08-G02(3)	8	G1/4	7.5	18.3	15	15	56.3	29	15	14
IPHT08-G03(3)		G3/8	7.5	19	15.7	15.7	64.4	30	15	19
IPHT08-G04(3)	10	G1/2	10	24.5	21.5	21.5	82	32.5	15	24
IPHT10-G01(3)		G1/8	5.5	16.8	19	19	61.5	30.3	19	12
IPHT10-G02(3)	10	G1/4	7.5	20	21.5	21.5	69.3	32.5	19	14
IPHT10-G03(3)		G3/8	7.5	21	21.2	21.2	75.4	33	19	19
IPHT10-G04(3)	12	G1/2	10	25	21.5	21.5	82	36	19	24
IPHT12-G02(3)		G1/4	7.5	21.5	21.5	21.5	69.3	33.5	21.5	14
IPHT12-G03(3)	12	G3/8	7.5	22	21.2	21.2	75.4	35.5	21.5	19
IPHT12-G04(3)		G1/2	10	26	21.5	21.5	82	36.5	21.5	24

IPHF-G 串联接头-G螺纹

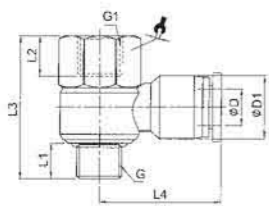

MODEL	ΦD	G	G1	L1	L2	L3	L4	ΦD1	🔧
IPHF04-G01	4	G1/8	G1/8	5.5	8.5	29	23.5	11.5	14
IPHF04-G02		G1/4	G1/4	7.5	11	35	25.5	11.5	17
IPHF06-G01	6	G1/8	G1/8	5.5	8.5	29	23.5	13.5	14
IPHF06-G02		G1/4	G1/4	7.5	11	35	25.4	13.5	17
IPHF06-G03	8	G3/8	G3/8	7.5	12	41	29.5	13.5	21
IPHF06-G04		G1/2	G1/2	10	14	47.5	32.5	13.5	24
IPHF08-G01	8	G1/8	G1/8	5.5	8.5	29	26.5	15	14
IPHF08-G02		G1/4	G1/4	7.5	11	35	28.9	15	17
IPHF08-G03	10	G3/8	G3/8	7.5	12	41	29.8	15	21
IPHF08-G04		G1/2	G1/2	10	14	47.5	32.5	15	24
IPHF10-G01	10	G1/8	G1/8	5.5	8.5	32	30.3	19	14
IPHF10-G02		G1/4	G1/4	7.5	11	36	32.6	19	17
IPHF10-G03	12	G3/8	G3/8	7.5	12	41	33	19	21
IPHF10-G04		G1/2	G1/2	10	14	47.5	36	19	24
IPHF12-G02	12	G1/4	G1/4	7.5	11	36	33.5	21.5	17
IPHF12-G03		G3/8	G3/8	7.5	12	41	35.5	21.5	21
IPHF12-G04	12	G1/2	G1/2	10	14	47.5	36.5	21.5	24

节流阀 SPEED CONTROLS



特点/ FEATURES

节流阀可控制空气装置的工作速度以及气压信号的传输
Accurate regulation of an optimal airflow rate of for precise motion control
该压缩设计可提供跟大功率设计一样的速度范围的变化
The compact design provides the comparable range of speed as the larger ones do.
限入型与限出型适合于各种型号
Control-out and control-in types are available for all models.
所有R跟NPT螺纹胶都起密封作用
All R and NPT threads are pre-coated sealant.
所有直螺纹都用标准的O型圈
All cylindrical threads are standard with O-Ring seals.

结构图/ STRUCTURE CHART

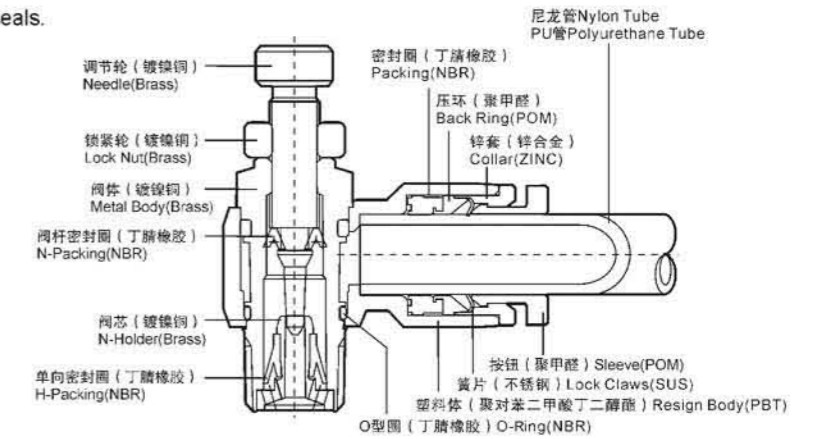

技术参数/ SPECIFICATIONS

使用流体/Fluid	空气 (无其他气体和液体) /Air (No other gases or liquids)	
使用压力范围/Operating Pressure	0-150PSI	0~9.9Kgf/cm ² (0~990kpa)
负压/Negative Pressure	7.5PSI	0.5 Kgf/cm ² (50Kpa)
使用温度范围/Operating Temperature	32~140°F	0~60°C
使用软管/ Applicable Tube	PU及尼龙/Polyurethane and Nylon	

控制方式/ CONTROL WAY

型号/Type	正装/Control out	反装/Control in
符号/Type	例: ISC06-01	例: ISC06-01B

当你定反装的节流阀时, 请在型号后面加上B, 比如: ISC06-01B。
When you order control in type, please put B at the end of model type. For example, ISC06-01B.



ISC 节流阀标准型

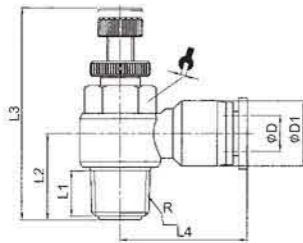

MODEL	ΦD	R	L1	L2	L3(max)	L4	ΦD1	⌘
ISC04-M5(B)	4	M5	3.5	12	32	20.5	11.5	8
ISC04-01(B)		R1/8	6.4	14	42	23.5	11.5	12
ISC04-02(B)		R1/4	10	18	48	25.5	11.5	14
ISC06-M5(B)	6	M5	3.5	12	32	22	13.5	8
ISC06-01(B)		R1/8	6.4	14	42	23.5	13.5	12
ISC06-02(B)		R1/4	10	18	48	25.4	13.5	14
ISC06-03(B)	6	R3/8	11.4	20.5	53	29.5	13.5	19
ISC06-04(B)		R1/2	14	25.5	61	32.5	13.5	24
ISC08-01(B)		R1/8	6.4	14.5	42	26.5	15	12
ISC08-02(B)	8	R1/4	10	19	48	28.9	15	14
ISC08-03(B)		R3/8	11.4	20.5	53	29.8	15	19
ISC08-04(B)		R1/2	14	25.5	61	32.5	15	24
ISC10-01(B)	10	R1/8	6.4	17.5	42	30.3	19	12
ISC10-02(B)		R1/4	10	20	48	32.6	19	14
ISC10-03(B)		R3/8	11.4	22.5	53	33	19	19
ISC10-04(B)	10	R1/2	14	25.5	61	36	19	24
ISC12-02(B)		R1/4	10	20	48	33.5	21.5	14
ISC12-03(B)		R3/8	11.4	24	53	35.5	21.5	19
ISC12-04(B)	12	R1/2	14	30	61	36.5	21.5	24

MODEL	ΦD	R	L1	L2	L3(max)	L4	ΦD1	⌘
ISC5/32-U10(B)	5/32	UNF10*32	3.5	12	32	22	11.5	5/16
ISC5/32-N01(B)		NPT1/8	6.4	14	42	23.5	11.5	7/16
ISC3/16-U10(B)	3/16	UNF10*32	3.5	12	32	22	11.5	5/16
ISC3/16-N01(B)		NPT1/8	6.4	14	42	23.5	11.5	7/16
ISC3/16-N02(B)	3/16	NPT1/4	10	18	48	25.5	11.5	9/16
ISC1/4-U10(B)		UNF10*32	3.5	12	32	22	13.5	5/16
ISC1/4-N01(B)	1/4	NPT1/8	6.4	14	42	23.5	13.5	7/16
ISC1/4-N02(B)		NPT1/4	10	18	48	25.4	13.5	9/16
ISC1/4-N03(B)	1/4	NPT3/8	11.4	20.5	53	29.5	13.5	3/4
ISC1/4-N04(B)		NPT1/2	14	25.5	61	32.5	13.5	1/1
ISC5/16-N01(B)	5/16	NPT1/8	6.4	14.5	42	26.5	15	7/16
ISC5/16-N02(B)		NPT1/4	10	19	48	28.9	15	9/16
ISC5/16-N03(B)	5/16	NPT3/8	11.4	20.5	53	29.8	15	3/4
ISC5/16-N04(B)		NPT1/2	14	25.5	61	32.5	15	1/1
ISC3/8-N01(B)	3/8	NPT1/8	6.4	17.5	42	30.3	19	7/16
ISC3/8-N02(B)		NPT1/4	10	20	48	32.6	19	9/16
ISC3/8-N03(B)	3/8	NPT3/8	11.4	22.5	53	33	19	3/4
ISC3/8-N04(B)		NPT1/2	14	25.5	61	36	19	1/1
ISC1/2-N02(B)	1/2	NPT1/4	10	20	48	33.5	21.5	9/16
ISC1/2-N03(B)		NPT3/8	11.4	24	53	35.5	21.5	3/4
ISC1/2-N04(B)	1/2	NPT1/2	14	30	61	36.5	21.5	1/1

ISCG 节流阀标准型-G螺纹

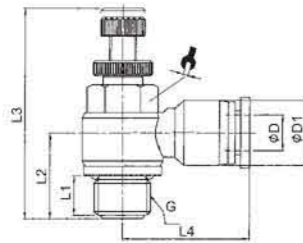

MODEL	ΦD	G	L1	L2	L3(max)	L4	ΦD1	⌘
ISC04-G01(B)	4	G1/8	5.5	14	42	23.5	11.5	12
ISC04-G02(B)		G1/4	7.5	18	48	25.5	11.5	14
ISC06-G01(B)		G1/8	5.5	14	42	23.5	13.5	12
ISC06-G02(B)	6	G1/4	7.5	18	48	25.4	13.5	14
ISC06-G03(B)		G3/8	7.5	20.5	53	29.5	13.5	19
ISC06-G04(B)		G1/2	10	25.5	61	32.5	13.5	24
ISC08-G01(B)	8	G1/8	5.5	14.5	42	26.5	15	12
ISC08-G02(B)		G1/4	7.5	19	48	28.9	15	14
ISC08-G03(B)		G3/8	7.5	20.5	53	29.8	15	19
ISC08-G04(B)	8	G1/2	10	25.5	61	32.5	15	24
ISC10-G01(B)		G1/8	5.5	17.5	42	30.3	19	12
ISC10-G02(B)		10	G1/4	7.5	20	48	32.6	19
ISC10-G03(B)	G3/8		7.5	22.5	53	33	19	19
ISC10-G04(B)	G1/2		10	25.5	61	36	19	24
ISC12-G02(B)	12	G1/4	7.5	20	48	33.5	21.5	14
ISC12-G03(B)		G3/8	7.5	24	53	35.5	21.5	19
ISC12-G04(B)		G1/2	10	30	61	36.5	21.5	24

ISS 自由转动型

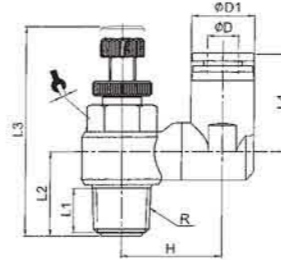

MODEL	ΦD	R	L1	L2	L3(max)	L4	H	ΦD1	⌘
ISS04-01(B)	4	R1/8	6.4	14	42	26.5	18	15	12
ISS04-02(B)		R1/4	10	17.5	48	27	20.5	15	14
ISS06-01(B)	6	R1/8	6.4	14	42	26.5	18	15	12
ISS06-02(B)		R1/4	10	17.5	48	27	20.5	15	14
ISS08-01(B)	8	R1/8	6.4	14	42	26.5	18	15	12
ISS08-02(B)		R1/4	10	17.5	48	27	20.5	15	14
ISS10-02(B)	10	R1/4	10	17.5	48	30	22	21.5	14
ISS10-03(B)		R3/8	11.4	21.5	53	31	23	21.5	19
ISS12-02(B)	12	R1/4	10	17.5	48	30	22	21.5	14
ISS12-03(B)		R3/8	11.4	21.5	53	31	23	21.5	19

MODEL	ΦD	R	L1	L2	L3(max)	L4	H	ΦD1	⌘
ISS1/4-N01(B)	1/4	NPT1/8	6.4	14	42	26.5	18	15	7/16
ISS1/4-N02(B)		NPT1/4	10	17.5	48	27	20.5	15	9/16
ISS5/16-N01(B)	5/16	NPT1/8	6.4	14	42	26.5	18	15	7/16
ISS5/16-N02(B)		NPT1/4	10	17.5	48	27	20.5	15	9/16
ISS3/8-N02(B)	3/8	NPT1/4	10	17.5	48	30	22	21.5	9/16
ISS3/8-N03(B)		NPT3/8	11.4	21.5	53	31	23	21.5	3/4
ISS1/2-N02(B)	1/2	NPT1/4	10	17.5	48	30	22	21.5	9/16
ISS1/2-N03(B)		NPT3/8	11.4	21.5	53	31	23	21.5	3/4

ISSG 自由转动型-G螺纹

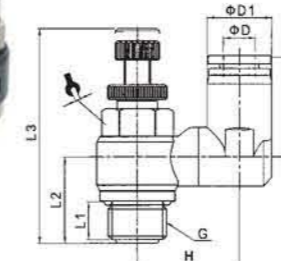

MODEL	ΦD	G	L1	L2	L3(max)	L4	H	ΦD1	⌘
ISS04-G01(B)	4	G1/8	5.5	14	42	26.5	18	15	12
ISS04-G02(B)		G1/4	7.5	17.5	48	27	20.5	15	14
ISS06-G01(B)	6	G1/8	5.5	14	42	26.5	18	15	12
ISS06-G02(B)		G1/4	7.5	17.5	48	27	20.5	15	14
ISS08-G01(B)	8	G1/8	5.5	14	42	26.5	18	15	12
ISS08-G02(B)		G1/4	7.5	17.5	48	27	20.5	15	14
ISS10-G02(B)	10	G1/4	7.5	17.5	48	30	22	21.5	14
ISS10-G03(B)		G3/8	7.5	21.5	53	31	23	21.5	19
ISS12-G02(B)	12	G1/4	7.5	17.5	48	30	22	21.5	14
ISS12-G03(B)		G3/8	7.5	21.5	53	31	23	21.5	19

ISU 管道阀

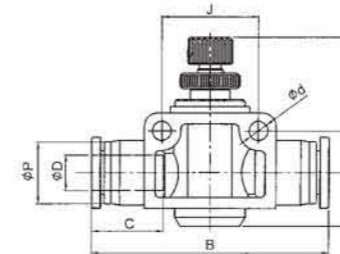

MODEL	ΦD	ΦP	B	C	G	F	S	Φd	J
ISU04	4	10.5	40.5	14.5	16	6.5	6.5	3.2	14
ISU06	6	12.5	48.7	15.5	25.5	8.5	11	4.3	20
ISU08	8	14	54.4	16.5	25	9.5	12	4.3	22
ISU10	10	18	64.3	19.5	29.5	10.5	12.5	4.3	26
ISU12	12	20.6	74.6	21	27.5	13	16	4.3	32

MODEL	ΦD	ΦP	B	C	G	F	S	Φd	J
ISU5/32	5/32	10.5	40.5	14.5	16	6.5	6.5	3.2	14
ISU3/16	3/16	10.5	40.5	14.5	16	6.5	6.5	3.2	14
ISU1/4	1/4	12.5	48.7	15.5	25.5	8.5	11	4.3	20
ISU5/16	5/16	14	54.4	16.5	25	9.5	12	4.3	22
ISU3/8	3/8	18	64.3	19.5	29.5	10.5	12.5	4.3	26
ISU1/2	1/2	20.6	74.6	21	27.5	13	16	4.3	32